

Valve Wheel Wrench



- » Provides leverage when opening or closing hand operated valve wheels
- » Each wrench fits a variety of sizes and shapes of valve wheels
- » Opening shape reduces the chance of slippage in overhead or crowded positions

Specifications

Part No.	Description	Length*	Weight
STEEL			
VW0	Forged, Double-end	8"	14 ozs.
VW0CPTC**	Forged, Double-end	8"	12 ozs.
VW10	Forged, Double-end	10"	1-3/4 lbs.
VW1	Forged, Single-end	15"	2-3/8 lbs.
VW12	Forged, Double-end	18"	4-1/4 lbs.
VW2	Forged, Single-end	22"	4-3/4 lbs.
VW3	Forged, Single-end	27"	10 lbs.
VW4	Forged, Single-end	48"	16-1/4 lbs.
VW5	Cast, Single-end	48"	16 lbs.
VW6	Cast, Single-end	48"	15-3/4 lbs.
BRONZE			
VW0BR	Cast, Double-end	8"	15-1/4 ozs.
VW10BR	Cast, Double-end	10"	1-7/8 lbs.
VW1BR	Cast, Single-end	15"	2-3/8 lbs.
VW12BR	Cast, Single-end	15-1/2"	2-7/8 lbs.
VW2BR	Cast, Single-end	22"	4-3/4 lbs.
VW3BR	Cast, Single-end	30"	9-1/8 lbs.
ALUMINUM			
VW0AL	Cast, Double-end	8"	5 ozs.
VW10AL	Cast, Double-end	10"	10-1/2 ozs.

*Overall Length is approximate

**Cadmium plated, Teflon coated



WARNING! Use as a hand tool only. Do Not Strike, use a "cheater" or extend handle. SERIOUS INJURY may result if used improperly.



NOTE: Safe Practices & Procedures can be found on page 38 of this product guide.

DIMENSIONS

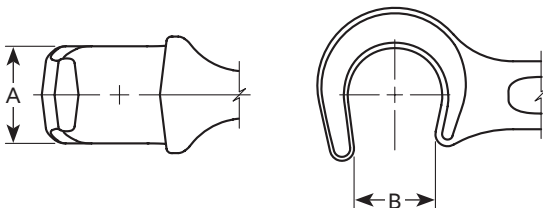

Size	A		B	
	Small	Large	Small	Large
0	5/8"	3/4"	1/2"	21/32"
0CPTC	7/16"	7/16"	1/2"	21/32"
10	7/8"	1-1/8"	11/16"	1"
1		1-1/4"		1"
12	1-1/8"	1-13/16"	1"	1-5/16"
12BR		1-3/8"		1-3/8"
2		1-13/16"		1-5/16"
3		2-1/2"		2"
4		2-11/16"		2-1/4"
5		2-3/4"		2-1/2"
6		2-7/8"		2-3/4"

Valve Wheel Wrench

SURGRIP™



- » Significantly reduce the chance of wrench slippage when opening and closing valves
- » Cast from durable, ductile iron
- » Head design provides a better grip and longer handles provide more leverage

Specifications

Part No.	Pattern	Overall Length*	Weight
VW0SG	Double-end	8"	14 ozs.
VW0LSG	Double-end	15"	1-3/8 lbs.
VW10SG	Double-end	10"	1-1/2 lbs.
VW12SG	Double-end	22"	4-5/8 lbs.
VW1SG	Single-end	22"	5 lbs.
VW2SG	Single-end	27"	5-5/8 lbs.
VW3SG	Single-end	27"	12 lbs.

*Overall Length is approximate

! WARNING! Use as a hand tool only. Do Not Strike, use a "cheater" or extend handle. SERIOUS INJURY may result if used improperly. **!**

NOTE: Safe Practices & Procedures can be found on page 38 of this product guide.

DIMENSIONS

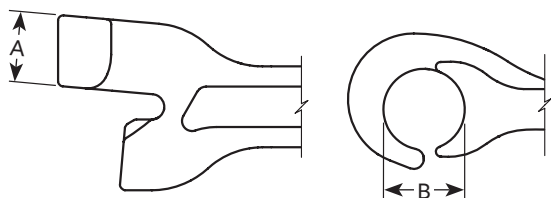

Size	A		B	
	Small	Large	Small	Large
VW0SG	1/2"	3/4"	1/2"	21/32"
VW0LSG	1/2"	3/4"	1/2"	21/32"
VW10SG	9/10"	1"	11/16"	1"
VW12SG	1-1/10"	1-1/4"	1"	1-5/16"
VW1SG	1-1/10"		1"	
VW2SG	1-1/4"		1-5/16"	
VW3SG	2-1/10"		2"	

Valve Wheel Wrench

100 Series



- » Made from aluminum-magnesium to reduce the chance of sparks when opening stubborn valves
- » Comfortable rounded gripping area on handle end
- » Base pad provides a better grip on valve wheel

Specifications

Part No.	Opening	Overall Length*	Weight
VW101AL	1-3/8"	13-5/8"	2-1/8 lbs.
VW102AL	1-3/4"	17-5/8"	3-1/2 lbs.
VW103AL	2-1/2"	25-1/2"	7-3/4 lbs.

*Overall Length is approximate

! WARNING! Protect yourself and others from SERIOUS INJURY! Use as a hand tool for gripping! NOT FOR STRIKING! Never use a "CHEATER" or other means to extend handle! Always pull toward base pad! If wrench slips you can be hurt or injure others! **!**

NOTE: Safe Practices & Procedures can be found on page 38 of this product guide.

Valve Wheel Wrench

El-Mac SURGRIP™



- » Made from aluminum-magnesium to minimize sparking
- » "Fist-like" head design reduces slipping on stubborn valves
- » Suitable for use in various industries

Specifications

Part No.	Opening	Overall Length*	Weight
EM9	7/8"	9"	13 ozs.
EM11	1"	11"	1-1/4 lbs.
EM15	1-3/8"	15"	2-1/4 lbs.
EM19	1-3/4"	19"	3-5/8 lbs.
EM28	2"	28"	7 lbs.

*Overall Length is approximate

! WARNING! Protect yourself and others from SERIOUS INJURY! Use as a hand tool for gripping! NOT FOR STRIKING! Never use a "CHEATER" or other means to extend handle! Always pull toward base pad! If wrench slips you can be hurt or injure others! **!**

NOTE: Safe Practices & Procedures can be found on page 38 of this product guide.

Valve Wheel Wrench



safer, more comfortable grip

- » Safely open and close stubborn valves
- » Deeper, more rounded design fits valve wheel rim better
- » Special feature fits over the spoke of valve wheel
- » Made from aluminum magnesium

Specifications

Part No.	Opening	Overall Length*	Weight
VWP1	1-3/8"	13-5/8"	2-1/4 lbs.
VWP2	1-3/4"	17-5/8"	3-7/8 lbs.
VWP3	2-1/2"	25-1/2"	7-5/8 lbs.

*Overall Length is approximate

! WARNING! Protect yourself and others from SERIOUS INJURY! Use as a hand tool for gripping! NOT FOR STRIKING! Never use a "CHEATER" or other means to extend handle! Always pull toward base pad! If wrench slips you can be hurt or injure others! **!**

NOTE: Safe Practices & Procedures can be found on page 38 of this product guide.

Valve Wheel Latch Wrench



- » Grips rim of valve wheel to prevent slipping
- » Latching mechanism pivots freely allowing wrench to be easily applied or removed from valve wheel
- » Made from alloy steel for strength and durability

Specifications

Part No.	Opening	Length	Weight
VWL1	1-3/16"	11-1/4"	3-1/2 lbs.

! WARNING! Protect yourself and others from SERIOUS INJURY! Never use a "cheater" or other means to extend handle! If wrench slips you can be hurt or injure other workers! **!**

NOTE: Safe Practices & Procedures can be found on page 38 of this product guide.